

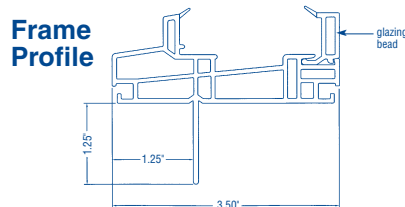

2. Broken Block Removal

2.1 Use the utility knife to cut through the silicone joint on all four sides of the glass block, both on the indoor and outdoor sides of the window. Suggestion: use the rubber mallet to gently tap the utility knife down through the silicone joints. While wearing protective gloves, carefully remove the broken block and dispose of properly.

2.2 If the broken block is next to the perimeter of the frame, first remove the glazing bead (see illustration). Using the putty knives for removal, locate the center of the glazing bead and carefully insert the tip of one putty knife into the joint between the frame and the glazing bead. Now insert the second putty knife tip into the opening and work it between the bead and the frame until the bead comes loose.

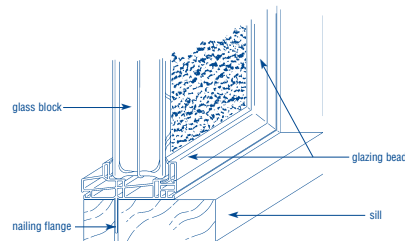

1. Required Tools

- Repair kit containing one tube of silicone sealant, nozzle, joint finishing tool (spoon) and repair instructions
- Safety glasses, protective gloves
- Two small, stiff putty knives
- Utility knife
- Rubber mallet
- Duct or masking tape
- Caulking gun

CAUTION: Care must be taken to prevent scratching or marring the bead and/or frame during this operation. Cut through the silicone joint around the block as in step 2.1. Remove the block and dispose of properly.

3. Block Cleaning

Clean the window frame of all silicone if the block was next to the perimeter.

4. New Block Installation

4.1 Stretch two pieces of duct or masking tape across the opening opposite the side where the new block will be installed. Insert the new block into the opening, align joints, and press it against the tape.

4.2 If a perimeter block is being replaced, apply a 1/4" bead of silicone sealant on the window frame (see illustration) before inserting the glass block.



5. Silicone Application

5.1 Puncture inner seal. Attach nozzle.

5.2 Apply a narrow bead (1/8" wide or less) of silicone in the open joint on the side of the window opposite the tape. It is not necessary or desirable to force a large quantity of silicone into the joints. If necessary, tool the silicone smooth using joint finishing tool. Inspect to assure a complete seal.

5.3 If a perimeter block is being replaced, apply a bead of silicone on the block edge where it contacts the frame.

5.4 After a minimum of 4 hours, remove the tape and spacers on the opposite side of the panel and seal the joints as in step 5.2.

6. Glazing Bead Replacement

If the glazing bead was removed during repair, slightly flex the bead and insert both ends into the corners of the frame. Carefully press the bead into place.

For assistance, call 1-800-624-2120.